

PENTHOUSE

PLAN

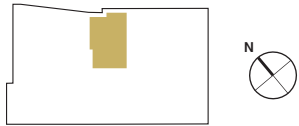

1 BEDROOM
1 BATH
from ~1,122 SQ FT



1050 SOUTH GRAND AVENUE
LOS ANGELES, CA 90015

WWW.TEN50.LA LIVE@TEN50.LA

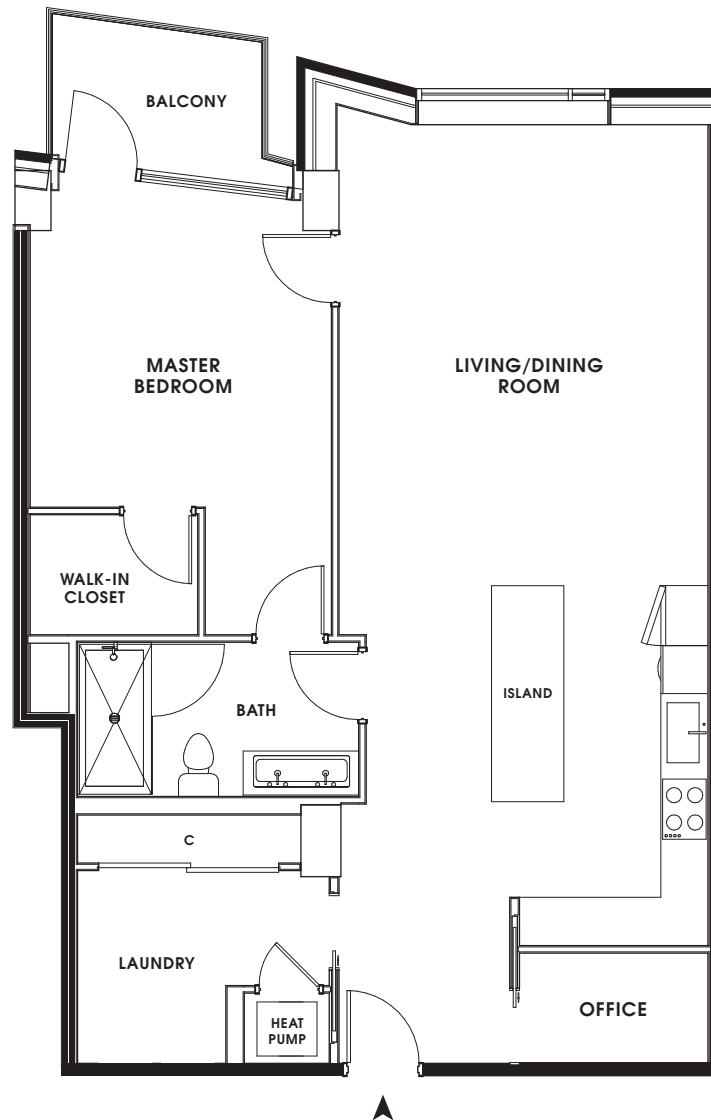

Plan not to scale. Trumark Urban and TEN50 reserve the right to make modifications in plans, exterior designs, prices, materials, specifications, finishes and standard features at any time without notice. Photographs, renderings and landscaping are illustrative and conceptual. All artist's renderings are for representational purposes only and subject to variances. Windows and floor plans vary per residence, elevation and type. Square footage is approximate and should not be relied upon as a representation, express or implied. All rights reserved. Real Estate Consulting, Sales and Marketing by Polaris Pacific—a licensed California, Arizona, Colorado, Hawaii, Oregon and Washington Broker—CA BRE #01499250. ©2017 TEN50. Brokers must accompany their client(s) and register them on their first appointment in order to be eligible for a broker commission.